

Appendix 8b

NOTES

ALL DIMENSIONS AND LEVELS ARE TO BE CHECKED ON SITE
 ANY DISCREPANCIES ARE TO BE REPORTED TO THE ARCHITECT BEFORE ANY WORK COMMENCES
 THIS DRAWING SHALL NOT BE SCALED TO ASCERTAIN ANY DIMENSIONS WORK TO FIGURED DIMS ONLY
 THIS DRAWING SHALL NOT BE REPRODUCED WITHOUT EXPRESS WRITTEN PERMISSION FROM AFL LTD.

The stadiums plans are based on an informal survey and verbal clarifications from the club's team. They do not reflect tenants detailed layouts, escape routes, etc. and should not be used for any other purposes.

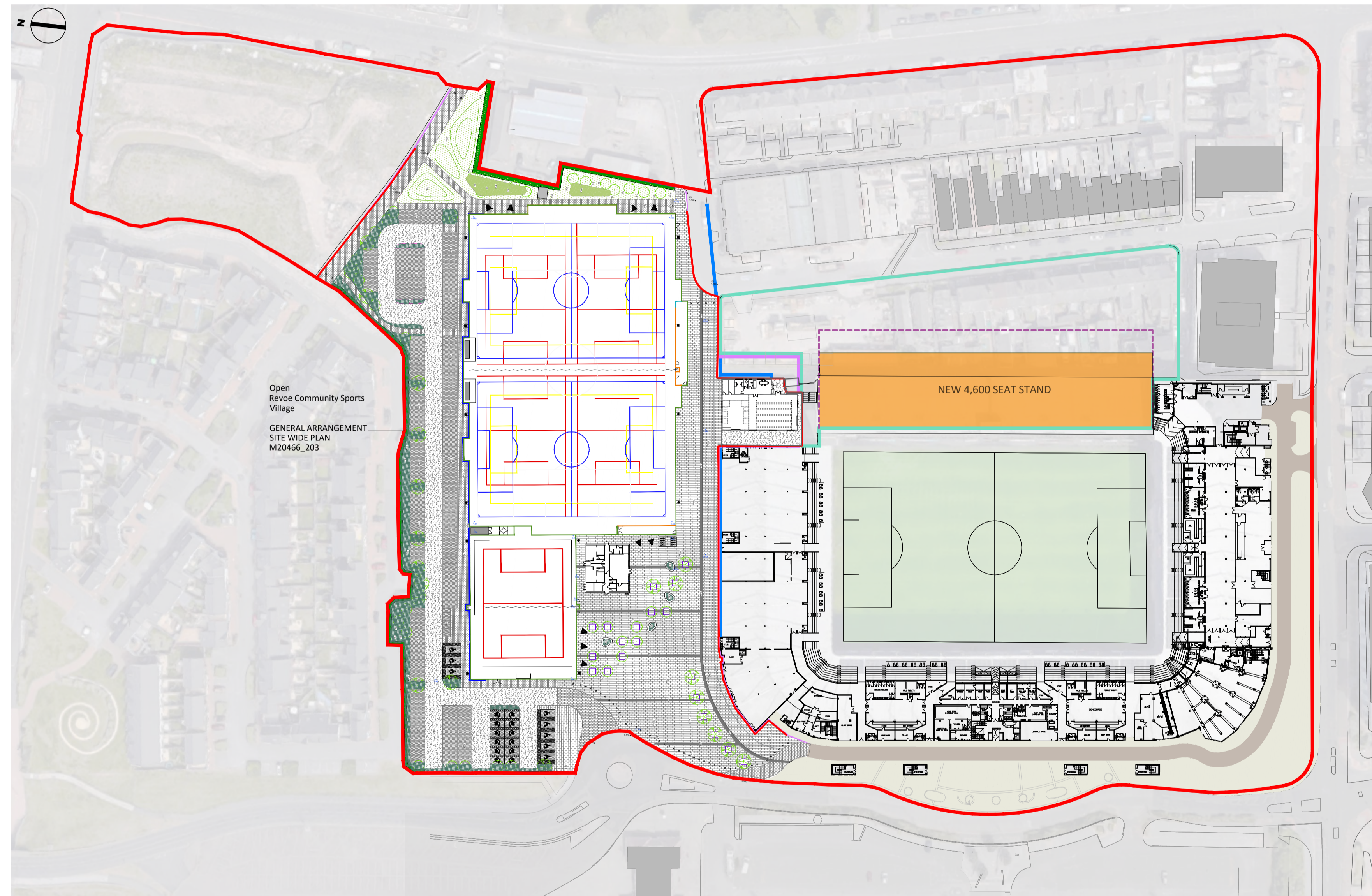

Key

Black line	Main pitch size: 105m x 68m (346ft x 223ft)
Blue line	7.5m pitch size: 110m x 70m (360ft x 229ft)
Yellow line	7.5m pitch size: 110m x 70m (360ft x 229ft)
Green line	2nd Stand: 20m x 37m (65ft x 121ft)
Red line	4th Stand: 40m x 30m (131ft x 98ft)
Black line	4.5m Fence
Blue line	2m Fence
Red line	1.5m Fence
Black line	Site Boundary Line
Purple line	Site Boundary - Site 1
Green line	Site Boundary - Site 2

P01 07/02/2023 - First Issue

rev	date/intis	description
project		
Bloomfield Road Masterplan		
location		
Blackpool		
client		
Blackpool FC		

AFL Architects
 1st Floor
 St Georges House
 56 Peter Street
 Manchester UK
 M2 3JQ
 t: +44(0)161 236 6263
 f: +44(0)161 236 6484
 w: www.afl-architects.com
 e: mail@afl-uk.com
 London office
 t: +44 (0)20 3096 9263



key plan

drawing title
 Masterplan proposal -
 Sports village overlay

dwg purpose
 job number
 211501

scale 1:200 drawn AK checked RO
 @ sheet size A1 rev date 07/02/2023

BPM-AFL-00-00-DR-A-00023 P01
 BIM no. co. zn. lev. type dis.seq. no. revision